



AN ISO 9001:2015 & ISO 14001:2015
CERTIFIED COMPANY

www.kptpipes.com

pneumato[™]
PNEUMATIC PIPES & FITTINGS



PP-GF Pneumatic and compressed Air Piping Systems

With a service life of atleast 50 years once installed, tight and safe.

Pioneers in India to have PPR-C Range from 16mm to 400mm



PNEUMATIC AIR AND COMPRESSED AIR PLUMBING PIPING SYSTEM

KPT Pneumato Pipes combine the advantages of FRP and plastic pipes and eliminate the disadvantages of both materials at the same time. The FRP is absolutely diffusion tight and reliably prevents oxygen or gases from permeating into the pipe. It compensates and reduces snap-back forces and heat expansion with changes in temperature. KPT Pneumato pipes are being produced with latest German technology at its state of the art manufacturing unit at Dehradun, Uttarakhand, India. KPT Pneumato pipes has been specially designed for the creation of primary and secondary network for compressed air, neutral gases & Vacuum. The FRP allows KPT Pneumato Pipes to withstand high working pressure and prevent oxygen and gases from permeating into the pipe. KPT Pneumato pipes are safe and reliable choice for compressed air, gas and oxygen supply.

KPT Pneumato Pipes consist of an overlapped FRP with an inner and outer layer of Polypropylene Random Copolymer (PPR-C). All the layers are permanently bonded together by intermediate adhesive layers. The FRP thickness of KPT Pneumato pipes has been selected to meet compressive and flexural strength requirements. Most of the industries are now slowly moving away from MS/GI piping system for compressed air transportation owing to following problems:

Reinforcement Glass Fiber - The Sandwich Glass Reinforcement technology processed on Pneumato enables to withstand more pressure even in high temperature. Since Glass is non-conductor of heat, so there is lesser thermal expansion, this reduces sagging.

U.V. Resistant - New Pneumato technology being developed with carbon content blue layer which protects the pipes from UV rays in open sky.

Glass Insulation - Glass acts as non-conductor of heat. So the Sandwich Glass Reinforcement technology reduces the condensation, thus reduces the chances of moisture in Pneumato technology getting least.

Leaking zero - in fusion welded joints.

Rusting - Water condensation in compressed air system leads to rust formation even in joint areas of GI pipe welding, affecting costlier pneumatic equipments.

Installation Time - Threaded joints consume more time in existing repair work as well as in new projects where as fusion joints once conducted require no maintainence.

Pressure Drop - Rough inner surface in the above pipes leads to slight increase in pressure drop.

Cost - Aluminium/MS/GI piping systems are conventionally more expensive.

Atmospheric effects - Aluminium also reacts with most of the chemicals. If some chemicals are present in compressed air, that can equally effect aluminium pipes. Often aluminium pipes are available at the maximum size of 110mm only. Most of the fittings are in plastics material. These areas are then rendered mechanically weaker in the line.

ADVANTAGES OF PNEUMATO PIPES

1. Very less heat loss due to lesser thermal conductivity.
2. Lesser sagging because of very less thermal expansion.
3. High temperature and high pressure with stand capacity due to inbuilt GFR reinforcement layer.
4. Since having 0.1micron RA value and mirror finish inner surface, 40% to 60% lesser friction compared to other pipe.
5. Reduced thermal expansion will reduce clamping.
6. Style fittings offer a tight, leak free fit.
7. As a result of socket Fusion joint, 0% leakage.
8. 60% layer of glass fiber reinforcement in the pipe.
9. Excellent performance with long life in direct sunlight having UV resistant on the upper layer.
10. Reduced linear expansion coefficient, only 1/3 of that of normal PP-R
11. Higher strength and stability of dimension. It can stand 25% more pressure than PP-R at the same condition
12. Improved resistant to impulse under low temperature. It can used in 90 ° for a long time
13. With the same condition of pressure, wall thickness of PPR fiberglass pipe is thinner, increasing inner diameter of the pipe, bigger of the air flow.
14. Direct connect with water table within the health of non-toxic, good scalability, no formation of sphagnum.

Technical Data of K.P.T. Pneumato Pipes:

S.No.	PROPERTY	(KPT-GF) PIPE
1	Thermal Conductivity	0.024
2	Coefficient Linear Thermal Expansion	1.0 X 10 ⁻⁴
3	Flexural Modulus	1260
4	Tensile Strength at break	45
5	Melting Temperature Rate	160-165
6	Vicat Softening Temperature	145.3

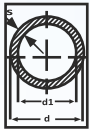

**KPT Pneumato Pipe
SDR 11/ S 5/ PN 10**

Pipe		Diameter	Wall Thickness	Internal Diameter	Air Content
Dimension	Packing Unit	d(mm)	S(mm)	di(mm)	litre/mtr
20mm	240m	20	1.9	16.2	0.206
25mm	180m	25	2.3	20.4	0.327
32mm	120m	32	2.9	26.2	0.539
40mm	75m	40	3.7	32.6	0.834
50mm	45m	50	4.6	40.8	1.307
63mm	30m	63	5.8	51.4	2.074
75mm	21m	75	6.8	61.4	2.959
90mm	15m	90	8.2	73.6	4.252
110mm	12m	110	10.0	90.0	6.359
125mm	9m	125	11.4	102.2	8.199
160mm	6m	160	14.6	130.8	13.430
200mm	3m	200	18.2	163.6	21.010
250mm	3m	250	22.7	204.6	32.861
315mm	3m	315	28.6	257.8	52.172
355mm	3m	355	32.2	290.6	66.292
400mm	3m	400	36.3	327.4	84.145

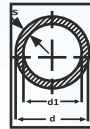

**KPT Pneumato Pipe
SDR 7.4/ S 3.2/ PN 16**

Pipe		Diameter	Wall Thickness	Internal Diameter	Air Content
Dimension	Packing Unit	d(mm)	S(mm)	di(mm)	litre/mtr
16mm	300m	16	2.2	11.6	0.106
20mm	240m	20	2.8	14.4	0.163
25mm	180m	25	3.5	18.0	0.254
32mm	120m	32	4.4	23.2	0.423
40mm	75m	40	5.5	29.0	0.660
50mm	45m	50	6.9	36.2	1.029
63mm	30m	63	8.6	45.8	1.647
75mm	21m	75	10.3	54.4	2.323
90mm	15m	90	12.3	65.4	3.358
110mm	9m	110	15.1	79.8	4.999
125mm	9m	125	17.1	90.8	6.472
160mm	6m	160	21.9	116.2	10.599
200mm	3m	200	27.4	145.2	16.550
250mm	3m	250	34.2	181.6	25.888
315mm	3m	315	43.4	228.2	40.879
355mm	3m	355	49.0	257	51.848
400mm	3m	400	55.2	289.6	65.837

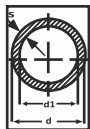

**KPT Pneumato Pipe
SDR 6/ S 2.5/ PN 20**

Pipe		Diameter	Wall Thickness	Internal Diameter	Air Content
Dimension	Packing Unit	d(mm)	S(mm)	di(mm)	litre/mtr
16mm	240m	16	2.7	10.6	0.088
20mm	210m	20	3.4	13.2	0.137
25mm	150m	25	4.2	16.6	0.216
32mm	105m	32	5.4	21.2	0.353
40mm	60m	40	6.7	26.6	0.555
50mm	36m	50	8.3	33.4	0.876
63mm	24m	63	10.5	42.0	1.385
75mm	21m	75	12.5	50.0	1.963
90mm	12m	90	15.0	60.0	2.826
110mm	9m	110	18.3	73.4	4.229
125mm	6m	125	20.8	83.4	5.460
160mm	3m	160	26.6	106.8	8.954

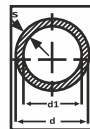

**KPT Pneumato Pipe
SDR 12.5/ S 4/ PN 12.5**

Pipe		Diameter	Wall Thickness	Internal Diameter	Air Content
Dimension	Packing Unit	d(mm)	S(mm)	di(mm)	litre/mtr
20mm	240m	20	2.2	15.6	0.190
25mm	180m	25	2.8	19.4	0.297
32mm	120m	32	3.6	24.9	0.486
40mm	75m	40	4.4	31.1	0.760
50mm	45m	50	5.6	38.9	1.187
63mm	30m	63	7.0	49.0	1.885
75mm	21m	75	8.3	58.3	2.671
90mm	15m	90	10.0	70.0	3.847
110mm	12m	110	12.2	85.6	5.746
125mm	9m	125	13.9	97.2	7.420
160mm	6m	160	17.8	124.4	12.157
200mm	3m	200	22.2	155.6	18.995
250mm	3m	250	27.8	194.4	29.680
315mm	3m	315	35.0	245.0	47.120
355mm	3m	355	39.4	276.1	59.846
400mm	3m	400	44.4	311.0	75.980

PERMISSIBLE WORKING PRESSURE

The below table list is the allowable working pressure for pipes with different pressure class under specific temperature and work life. Under normal work pressure and conditions, the life of KPT PPR Piping system is guaranteed to be 50 years at least.

Temperature in C	Years of Service	Allowable working pressure, in bar for			
		PN-10 (SDR 11)	PN-12.5 (SDR 9)	PN-16 (SDR 7.4)	PN-20 (SDR 6)
10°C	1	20.5	28.8	34.8	43.8
	5	19.1	27.8	33.0	41.5
	10	18.5	27.5	31.9	40.1
	25	17.8	27.0	30.9	38.9
	50	17.3	26.6	30.0	37.9
20°C	1	18.8	25.1	29.8	37.5
	5	17.6	24.2	27.9	35.1
	10	17.1	23.9	27.1	34.1
	25	16.6	23.5	26.4	33.1
	50	16.1	23.2	28.5	32.1
30°C	1	16.0	21.7	25.3	31.9
	5	15.0	20.9	23.8	29.9
	10	14.5	20.6	22.9	28.9
	25	14.0	20.3	22.1	27.9
	50	13.6	19.9	21.6	27.3
40°C	1	13.5	18.6	21.4	26.9
	5	12.6	18.0	20.0	25.3
	10	12.3	17.6	19.5	24.5
	25	11.8	17.3	18.8	23.5
	50	11.5	17.0	18.1	22.9
50°C	1	11.4	16.0	18.0	22.8
	5	10.6	15.4	16.9	21.3
	10	10.3	15.1	16.4	20.6
	25	10.0	14.8	15.8	19.9
	50	9.6	14.5	15.3	19.3

Temperature in C	Years of Service	Allowable working pressure, in bar for			
		PN-10 (SDR 11)	PN-12.5 (SDR 9)	PN-16 (SDR 7.4)	PN-20 (SDR 6)
60°C	1	9.5	13.4	15.1	19.1
	5	9.0	13.0	14.3	17.9
	10	8.6	12.7	13.8	17.3
	25	8.4	12.5	13.1	16.6
	50	8.0	12.2	12.6	15.6
70°C	1	8.1	11.3	12.9	16.3
	5	7.5	10.9	11.9	14.9
	10	7.4	10.7	11.6	14.6
	25	6.4	9.1	10.0	12.6
	50	5.4	7.6	8.4	10.6
80°C	1	6.9	9.5	10.8	13.6
	5	6.0	9.0	9.5	12.0
	10	5.0	7.4	7.9	10.0
	25	4.0	6.0	6.4	8.0
	95°C	1	4.9	7.1	7.6
5		3.1	4.6	5.0	6.3
10		2.6	3.7	4.3	5.3
110°C	1	2.9	3.7	5.0	5.6
	5	2.0	2.6	3.0	3.5

The bracketed values apply where testing can be shown to have been carried out for longer than one year at 120°C.

KPT PNEUMATO FITTINGS

Coupling

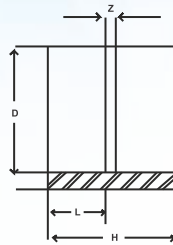
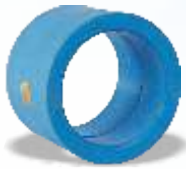

CODE	SIZE	D	L	Z	H
KPT C-0001	20 MM	19.2	14.5	3.9	32.9
KPT C-0002	25 MM	24.1	18.0	2.6	38.6
KPT C-0003	32 MM	31.0	18.4	3.0	39.8
KPT C-0004	40 MM	38.9	20.7	3.4	44.8
KPT C-0005	50 MM	48.0	24.4	3.1	51.9
KPT C-0006	63 MM	60.7	28.2	8.2	64.6
KPT C-0007	75 MM	71.9	31.5	4.0	67.0
KPT C-0008	90 MM	86.4	32.5	6.1	71.1
KPT C-0009	110 MM	106.8	38.8	3.0	80.6
KPT C-0010	160 MM	153.0	42.5	5.4	90.4

Elbow 90°

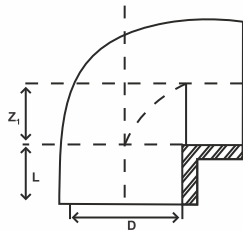

CODE	SIZE	D	L	Z
KPT E90-0021	20 MM	19.1	15.5	10.9
KPT E90-0022	25 MM	24.2	16.9	14.1
KPT E90-0023	32 MM	31.1	18.0	16.4
KPT E90-0024	40 MM	39.5	20.0	20.0
KPT E90-0025	50 MM	48.4	23.8	26.2
KPT E90-0026	63 MM	60.5	27.4	32.2
KPT E90-0027	75 MM	72.6	31.5	38.0
KPT E90-0028	90 MM	86.8	33.0	44.7
KPT E90-0029	110 MM	106.5	39.0	54.8
KPT E90-0030	160 MM	153.6	45.0	78.7
KPT E90-0031	200MM
KPT E90-0032	250MM
KPT E90-0033	315MM
KPT E90-0034	355MM
KPT E90-0035	400MM

Elbow 45°

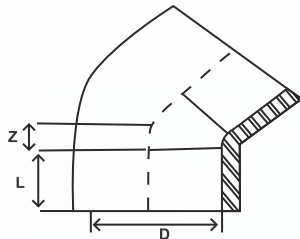
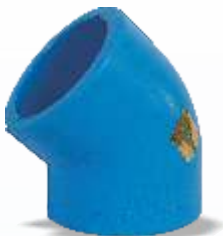

CODE	SIZE	D	L	Z
KPT E45-0041	20 MM	19.3	15.5	6.0
KPT E45-0042	25 MM	23.7	17.6	7.0
KPT E45-0043	32 MM	30.6	16.5	8.0
KPT E45-0044	40 MM	38.2	21.3	9.0
KPT E45-0045	50 MM	47.7	22.5	12.0
KPT E45-0046	63 MM	60.0	26.0	13.0
KPT E45-0047	75 MM	72.5	26.7	20.0
KPT E45-0048	90 MM	86.8	34.5	32.0
KPT E45-0049	110 MM	106.2	35.3	40.0
KPT E45-0050	160 MM	154.9	48.2	50.0
KPT E45-0051	200MM
KPT E45-0052	250MM
KPT E45-0053	315MM
KPT E45-0054	355MM
KPT E45-0055	400MM

Equal Tee

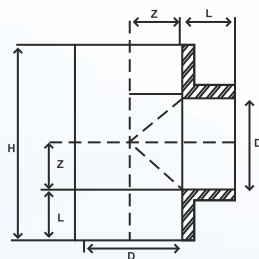

CODE	SIZE	D	L	Z	H
KPT ET-0061	20 MM	19.3	15.8	10.5	52.6
KPT ET-0062	25 MM	24.2	18.0	12.7	61.4
KPT ET-0063	32 MM	31.4	20.2	16.3	72.5
KPT ET-0064	40 MM	39.0	20.3	20.9	82.4
KPT ET-0065	50 MM	48.6	24.4	24.5	97.8
KPT ET-0066	63 MM	61.7	27.4	32.6	120.0
KPT ET-0067	75 MM	72.2	31.3	36.7	136.0
KPT ET-0068	90 MM	86.9	32.9	47.1	160.0
KPT ET-0069	110 MM	106.7	38.8	55.3	188.2
KPT ET-0070	160 MM	153.7	45.0	85.0	260.0
KPT ET-0071	200MM
KPT ET-0072	250MM
KPT ET-0073	315MM
KPT ET-0074	355MM
KPT ET-0075	400MM

Reducing Elbow

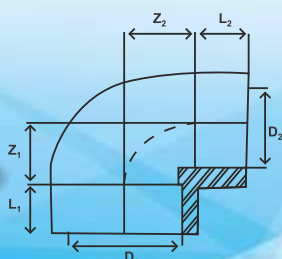

CODE	SIZE	D1	D2	L1	L2	Z1	Z2
KPT RE-0121	25/20	24.0	19.2	18.5	16.0	17.8	14.4
KPT RE-0122	32/20	31.3	19.2	21.1	16.0	18.3	18.0
KPT RE-0123	32/25	31.3	24.2	20.0	17.8	22.2	20.7
KPT RE-0124	40/20	38.7	19.2	21.6	16.3	19.6	24.2
KPT RE-0125	40/25	38.7	24.2	21.6	17.8	21.4	20.7
KPT RE-0126	40/32	38.6	31.2	21.9	19.8	24.2	25.3

Reducer

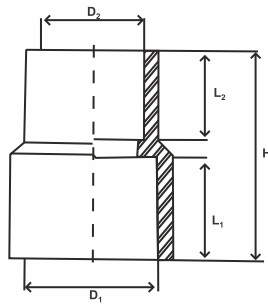

CODE	SIZE	D1	D2	L1	L2	H
P-KPT R-0081	25/20	24.0	19.2	18.5	15.7	38.1
P-KPT R-0082	32/20	31.3	19.2	20.0	15.7	39.3
P-KPT R-0083	32/25	31.4	24.4	21.0	18.4	41.7
P-KPT R-0084	40/20	38.7	19.3	22.9	16.9	48.0
P-KPT R-0085	40/25	39.0	24.2	24.2	18.0	48.5
P-KPT R-0086	40/32	38.6	31.0	21.1	18.8	44.9
P-KPT R-0087	50/20	48.0	18.8	24.6	16.6	44.5
P-KPT R-0088	50/25	48.0	23.8	24.5	16.2	45.6
P-KPT R-0089	50/32	48.0	31.1	24.4	18.0	48.1
P-KPT R-0090	50/40	48.2	38.8	24.3	20.9	48.2
P-KPT R-0091	63/20	60.9	19.2	28.2	15.9	48.3
P-KPT R-0092	63/25	60.7	24.1	28.2	18.0	49.5
P-KPT R-0093	63/32	60.6	30.7	28.0	18.0	48.0
P-KPT R-0094	63/40	60.8	38.3	25.3	25.5	56.8
P-KPT R-0095	63/50	60.9	48.2	29.2	25.8	64.8
P-KPT R-0096	75/20	72.5	19.0	42.7	21.1	63.8
P-KPT R-0097	75/25	72.5	24.3	42.7	21.1	63.8
P-KPT R-0098	75/32	72.5	31.0	42.7	21.1	63.8
P-KPT R-0099	75/40	72.2	38.7	31.6	22.5	63.6
P-KPT R-0100	75/50	72.1	48.4	31.7	27.0	63.2
P-KPT R-0101	75/63	71.8	60.9	31.4	30.0	67.0
P-KPT R-0102	90/20	87.3	19.0	43.5	27.0	70.5
P-KPT R-0103	90/25	87.3	24.1	43.5	27.0	70.5
P-KPT R-0104	90/32	87.3	31.0	42.5	27.0	70.5
P-KPT R-0105	90/40	87.3	38.9	42.5	27.0	70.5
P-KPT R-0106	90/50	86.5	48.1	33.0	26.3	70.0
P-KPT R-0107	90/63	86.6	60.9	32.8	29.9	68.8
P-KPT R-0108	90/75	86.7	72.7	37.2	31.5	71.7
P-KPT R-0109	110/20	106.8	19.0	58.1	19.5	76.0
P-KPT R-0110	110/25	106.8	24.0	53.3	19.2	76.0
P-KPT R-0111	110/32	106.8	31.0	57.6	19.5	76.0
P-KPT R-0112	110/40	106.8	39.0	56.6	19.3	76.0
P-KPT R-0113	110/50	106.8	48.4	38.9	26.0	76.0
P-KPT R-0114	110/63	106.8	61.2	38.9	30.1	76.0
P-KPT R-0115	110/75	106.8	72.6	38.9	31.8	76.0
P-KPT R-0116	110/90	106.8	86.6	38.9	33.0	76.0
P-KPT R-0117	160/20	155.3	18.9	61.8	29.5	91.2
P-KPT R-0118	160/25	155.3	23.9	61.8	29.5	91.2
P-KPT R-0119	160/32	155.3	30.6	61.8	29.5	91.2
P-KPT R-0120	160/40	155.3	38.7	61.8	29.5	91.2
P-KPT R-0121	160/50	155.3	48.5	61.8	29.5	91.2
P-KPT R-0122	160/63	155.3	61.8	61.8	29.5	91.2
P-KPT R-0123	160/75	155.3	73.5	61.8	29.5	91.2
P-KPT R-0124	160/90	155.3	86.6	61.8	29.5	91.2
P-KPT R-0125	160/110	155.3	106.3	61.8	29.5	91.2

Reducing Tee

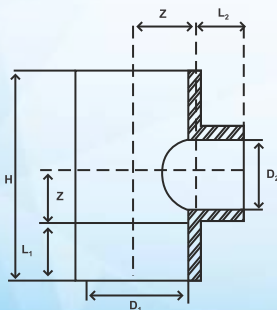

CODE	SIZE	D1	D2	L1	L2	Z	H
P-KPT RT-0141	25/20/25	24.2	19.1	17.6	16.2	10.8	56.8
P-KPT RT-0142	32/20/32	31.1	19.1	19.8	16.5	11.3	62.2
P-KPT RT-0143	32/25/32	31.4	24.2	20.0	17.8	13.4	66.8
P-KPT RT-0144	40/20/40	39.0	19.1	21.4	16.5	11.1	65.0
P-KPT RT-0145	40/25/40	38.8	24.2	21.4	17.6	13.5	69.8
P-KPT RT-0146	40/32/40	38.8	31.0	21.4	19.5	16.8	76.4
P-KPT RT-0147	50/20/50	48.4	19.1	24.4	18.1	24.5	97.7
P-KPT RT-0148	50/25/50	48.6	24.1	24.3	17.9	24.7	98.0
P-KPT RT-0149	50/32/50	48.6	30.5	24.3	18.8	24.6	97.8
P-KPT RT-0150	50/40/50	48.6	38.7	22.4	22.0	26.1	96.9
P-KPT RT-0151	63/20/63	61.2	19.0	27.5	16.2	32.2	119.4
P-KPT RT-0152	63/25/63	61.3	23.8	27.5	19.4	32.2	119.4
P-KPT RT-0153	63/32/63	61.3	30.8	27.5	19.3	32.2	119.4
P-KPT RT-0154	63/40/63	61.3	38.9	27.3	22.5	32.4	119.4
P-KPT RT-0155	63/50/63	61.2	48.0	27.4	25.8	32.3	119.4
P-KPT RT-0156	75/20/75	72.5	19.0	31.4	15.9	26.4	115.5
P-KPT RT-0157	75/25/75	72.5	24.0	31.4	17.6	26.4	115.5
P-KPT RT-0158	75/32/75	72.5	30.9	31.4	19.7	26.4	115.5
P-KPT RT-0159	75/40/75	72.3	38.4	31.4	20.3	26.4	115.5
P-KPT RT-0160	75/50/75	72.3	47.9	31.4	29.8	26.4	115.5
P-KPT RT-0161	75/63/75	72.2	60.2	31.4	29.8	26.4	115.5
P-KPT RT-0162	90/20/90	86.5	19.0	32.8	15.6	31.3	128.1
P-KPT RT-0163	90/25/90	86.5	24.0	32.8	17.6	31.3	128.1
P-KPT RT-0164	90/32/90	86.5	31.0	32.8	19.5	31.3	128.1
P-KPT RT-0165	90/40/90	86.5	38.6	32.8	21.2	31.3	128.1
P-KPT RT-0166	90/50/90	86.5	48.1	32.8	26.0	31.3	128.1
P-KPT RT-0167	90/63/90	86.5	61.2	32.8	30.1	31.3	128.1
P-KPT RT-0168	90/75/90	86.5	72.4	32.9	31.7	46.9	159.5
P-KPT RT-0169	110/20/110	106.5	19.0	38.7	15.8	38.5	154.3
P-KPT RT-0170	110/25/110	106.5	24.2	38.7	17.7	38.5	154.3
P-KPT RT-0171	110/32/110	106.5	31.0	38.7	19.7	38.5	154.3
P-KPT RT-0172	110/40/110	106.5	38.9	38.7	21.5	38.5	154.3
P-KPT RT-0173	110/50/110	106.5	48.6	38.9	26.2	38.3	154.3
P-KPT RT-0174	110/63/110	106.7	61.3	39.0	30.2	38.2	154.3
P-KPT RT-0175	110/75/110	106.4	72.5	39.0	32.0	38.2	154.3
P-KPT RT-0176	110/90/110	106.7	87.1	38.9	33.0	54.8	187.4
P-KPT RT-0177	160/20/160	155.4	19.0	45.0	15.8	80.9	251.8
P-KPT RT-0178	160/25/160	155.4	23.8	45.0	18.5	80.9	251.8
P-KPT RT-0179	160/32/160	155.4	31.0	45.0	19.5	80.9	251.8
P-KPT RT-0180	160/40/160	155.4	38.9	45.0	21.5	80.9	251.8
P-KPT RT-0181	160/50/160	155.4	48.8	45.0	25.4	80.9	251.8
P-KPT RT-0182	160/63/160	157.5	61.9	45.0	27.6	80.9	251.8
P-KPT RT-0183	160/75/160	157.5	73.9	45.0	32.1	80.9	251.8
P-KPT RT-0184	160/90/160	157.5	88.5	45.0	33.0	80.9	251.8
P-KPT RT-0185	160/110/160	157.5	107.4	45.0	44.9	80.9	251.8

Slip On (PPR C Steel Inlay Flange)

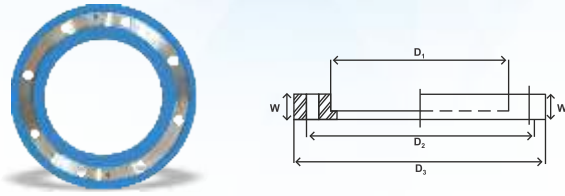

CODE	SIZE	D1	D3/PCD	W	TABLE	BOLT
KPT F-0229	90 MM	
KPT F-0230	110 MM	
KPT F-0231	160 MM	196.3	260.4	26.0	F	12
KPT F-0232	200 MM	217.0	292.1	24.5	D	8
KPT F-0233	250 MM	267.0	355.6	27.5	D	8
KPT F-0234	315 MM	323.0	406.4	32.6	D	12

Flange Core(Stub End)

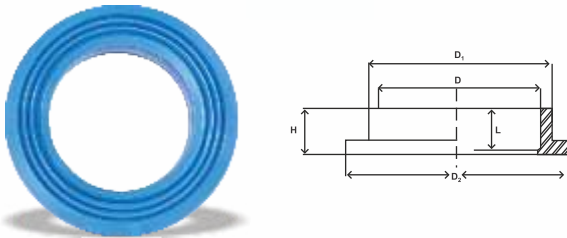

CODE	SIZE	D	D1	D2	L	H
KPT FC-0201	32 MM	31.1	42.9	50.5	19.9	23.3
KPT FC-0202	40 MM	31.1	49.6	60.2	20.3	25.8
KPT FC-0203	50 MM	48.1	62.6	72.3	22.2	27.2
KPT FC-0204	63 MM	61.0	80.7	95.0	20.9	35.4
KPT FC-0205	75 MM	72.6	95.0	111.3	31.9	39.0
KPT FC-0206	90 MM	87.1	111.8	129.4	24.2	42.1
KPT FC-0207	110 MM	106.8	133.3	151.0	25.4	43.3
KPT FC-0208	160 MM	155.0	194.4	214.0	31.0	52.8
KPT FC-0209	200MM	166.9	212.2	253.7	55.0	83.8
KPT FC-0210	250MM	214.5	263.0	310.5	53.0	84.4
KPT FC-0211	315MM
KPT FC-0212	355MM
KPT FC-0213	400MM

Slip-on(PPR Flanges)

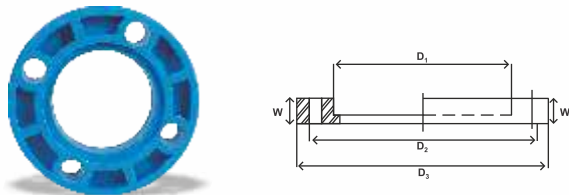

CODE	SIZE	D1	D2	D3	W
KPT F-0221	32 MM	43.6	97.0	115.7	20.6
KPT F-0222	40 MM	50.0	109.0	128.0	21.6
KPT F-0223	50 MM	62.5	122.0	140.7	22.5
KPT F-0224	63 MM	83.0	141.4	157.4	24.3
KPT F-0225	75 MM	97.0	175.3	172.3	26.2
KPT F-0226	90 MM	113.7	178.3	194.8	26.4
KPT F-0227	110 MM	135.7	197.9	216.0	30.6
KPT F-0228	160 MM	195.8	266.0	292.0	35.5

Plain Union

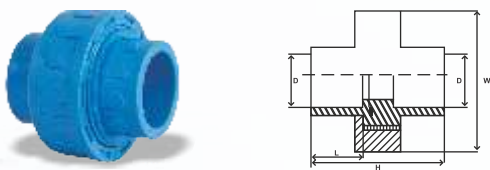

CODE	SIZE	D	L	W	H
KPT U-0241	20 MM	19.2	17.7	52.2	44.4
KPT U-0242	25 MM	24.2	18.6	51.4	55.2
KPT U-0243	32 MM	31.2	22.1	61.5	67.5
KPT U-0244	40 MM	39.2	29.2	79.0	79.9
KPT U-0245	50 MM	47.7	23.6	78.0	96.1
KPT U-0246	63 MM	60.7	27.7	89.0	107.6

4Way/Cross Tee

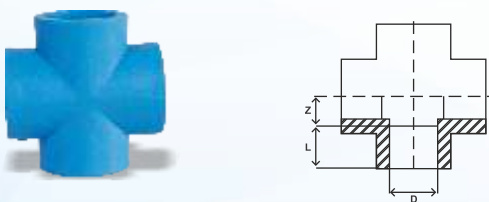

CODE	SIZE	D	L	Z
KPT CT-0261	20 MM	18.8	15.5	15.4
KPT CT-0262	25 MM	24.1	17.1	24.9
KPT CT-0263	32 MM	30.6	17.8	32.2
KPT CT-0264	40 MM	38.0	20.8	39.2
KPT CT-0265	50 MM	48.0	21.3	52.2
KPT CT-0266	63 MM	60.7	23.3	63.6

Pipe Clamp

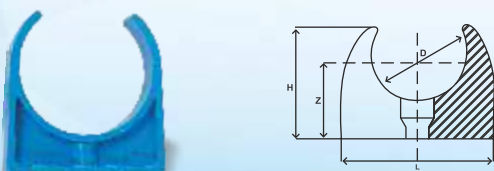

CODE	SIZE	D	L	Z	H
KPT PC-0281	20 MM	18.9	27.0	19.2	31.0
KPT PC-0282	25 MM	24.0	32.0	21.0	36.0
KPT PC-0283	32 MM	30.7	39.5	27.5	43.5
KPT PC-0284	40 MM	39.1	48.3	30.9	49.8
KPT PC-0285	50 MM	50.0	60.0	37.3	61.5
KPT PC-0286	63 MM	63.0	74.7	45.0	75.3

Long Plug

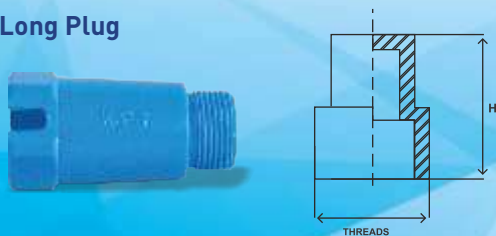

CODE	SIZE	THREADS	H
KPT LP-0301	1/2"	1/2"	69.7
KPT LP-0302	3/4"	3/4"	62.2
KPT LP-0303	1"	1"	73.6

Tank Connector

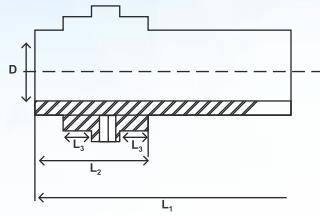

CODE	SIZE	D	L1	L2	L3
KPT TC-0321	20 MM	19.2	69.0	43.6	15.2
KPT TC-0322	25 MM	24.1	69.0	52.5	19.5
KPT TC-0323	32 MM	30.6	74.3	54.5	21.5
KPT TC-0324	40 MM	38.4	88.4	55.3	25.6
KPT TC-0325	50 MM	48.3	96.7	58.4	24.6
KPT TC-0326	63 MM	60.7	101.5	65.5	27.0

Ball Valve

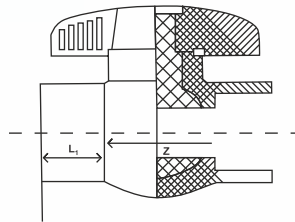

CODE	SIZE	D	L	Z	H
KPT BV-0341	20 MM	19.1	23.0	32.4	78.4
KPT BV-0342	25 MM	24.1	24.8	39.6	89.2
KPT BV-0343	32 MM	31.0	25.1	51.8	102.0
KPT BV-0344	40 MM	38.9	29.6	53.7	112.9
KPT BV-0345	50 MM	49.2	34.5	60.8	129.8
KPT BV-0346	63 MM	61.6	37.3	70.9	145.5
KPT BV-0347	75 MM	73.4	40.5	85.7	166.7
KPT BV-0348	90 MM	87.4	40.7	97.2	178.6
KPT BV-0349	110 MM	106.6	41.9	107.9	191.7

Ball Valve Plastic (Single Lever)

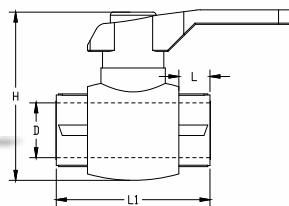

CODE	SIZE	D	L	L1	H
KPT BV-0351	20 MM	19.4	66.0	17.0	65.0
KPT BV-0352	25 MM	24.4	73.2	17.3	75.9
KPT BV-0353	32 MM	31.5	85.3	20.9	83.9
KPT BV-0354	40 MM	39.4	111.8	24.5	112.6
KPT BV-0355	50 MM	49.5	116.3	27.5	120.0
KPT BV-0356	63 MM	61.7	149.0	37.0	141.7
KPT BV-0357	75 MM
KPT BV-0358	90 MM
KPT BV-0359	110 MM

Male Threaded Coupling

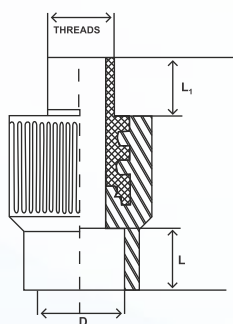

CODE	SIZE	THREADS	D	L	L1	H
KPT MTC-0361	20*1/2	1/2"	19.2	16.2	14.2	57.0
KPT MTC-0362	25*1/2	1/2"	23.8	18.3	14.2	56.0
KPT MTC-0363	25*3/4	3/4"	24.1	18.2	14.1	59.1
KPT MTC-0364	32*1/2	1/2"	31.1	19.8	14.0	64.5
KPT MTC-0365	32*3/4	3/4"	31.1	20.3	14.2	67.8
KPT MTC-0366	32*1	1"	31.1	20.2	28.0	71.8
KPT MTC-0367	40*1-1/4	1 1/4"	38.8	22.1	14.1	76.0
KPT MTC-0368	50*1-1/2	1 1/2"	48.9	25.5	21.3	80.0
KPT MTC-0369	63*2	2"	62.2	29.5	26.3	95.2
KPT MTC-0370	75*2-1/2	2 1/2"	72.0	32.4	24.9	100.5
KPT MTC-0371	90*3	3"	86.4	38.2	24.6	109.2
KPT MTC-0372	110*4	4"	104.9	38.1	25.5	119.0

Female Threaded Coupling

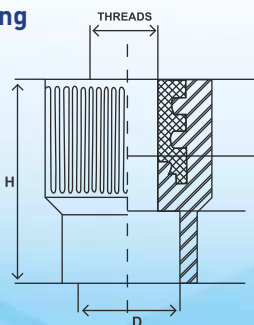

CODE	SIZE	THREADS	D	L	L1	H
KPT FTC-0391	20*1/2	1/2"	19.2	16.0	15.0	43.2
KPT FTC-0392	20*3/4	3/4"	23.6	18.0	14.9	41.8
KPT FTC-0393	25*1/2	1/2"	23.6	18.0	14.9	41.8
KPT FTC-0394	25*3/4	3/4"	24.1	18.1	15.7	45.0
KPT FTC-0395	32*1/2	1/2"	31.1	20.0	15.0	50.5
KPT FTC-0396	32*3/4	3/4"	31.1	20.4	16.0	52.0
KPT FTC-0397	32*1	1"	31.1	20.2	17.8	54.7
KPT FTC-0398	40*1-1/4	1 1/4"	38.8	22.1	18.0	62.0
KPT FTC-0399	50*1-1/2	1 1/2"	48.8	25.3	18.5	58.0
KPT FTC-0401	63*2	2"	61.5	28.6	25.6	68.1
KPT FTC-0402	75*2-1/2	2 1/2"	71.8	31.7	20.2	89.2
KPT FTC-0403	90*3	3"	86.5	38.0	21.9	101.5
KPT FTC-0404	110*4	4"	106.1	38.2	26.3	116.8

Male Threaded Tee

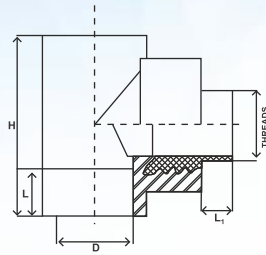

CODE	SIZE	THREADS	D	L	L1	H
KPT FTT-0421	20*1/2	1/2"	19.2	15.0	14.0	58.2
KPT FTT-0422	20*3/4	3/4"	19.2	15.0	14.0	58.2
KPT FTT-0423	25*1/2	1/2"	24.2	14.9	14.0	62.2
KPT FTT-0424	25*3/4	3/4"	24.2	16.2	13.9	63.8
KPT FTT-0425	32*1/2	1/2"	31.3	15.0	14.2	78.0
KPT FTT-0426	32*3/4	3/4"	31.3	16.2	14.2	78.2
KPT FTT-0427	32*1	1"	31.2	17.7	15.8	77.8
KPT FTT-0428	40*1-1/4	1 1/4"	39.0	17.6	15.2	91.0

Female Threaded Tee

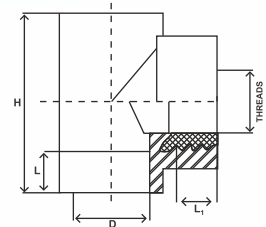

CODE	SIZE	THREADS	D	L	L1	H
KPT MTT-0441	20*1/2	1/2"	19.2	16.5	14.0	58.2
KPT MTT-0442	20*3/4	3/4"	19.2	16.5	14.0	58.2
KPT MTT-0443	25*1/2	1/2"	24.2	18.2	14.0	62.2
KPT MTT-0444	25*3/4	3/4"	24.2	17.6	13.9	63.8
KPT MTT-0445	32*1/2	1/2"	31.3	20.0	14.2	78.0
KPT MTT-0446	32*3/4	3/4"	31.3	20.0	14.2	78.2
KPT MTT-0447	32*1	1"	31.2	20.0	15.8	77.8
KPT MTT-0448	40-1-1/4	1 1/4"	39.0	21.4	15.2	91.0

Female Threaded Elbow

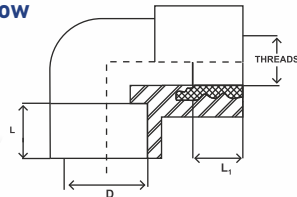

CODE	SIZE	THREADS	D	L	L1
KPT FTE-0461	20*1/2	1/2"	19.2	16.1	16.0
KPT FTE-0463	25*1/2	1/2"	24.1	17.9	15.0
KPT FTE-0464	25*3/4	3/4"	24.2	17.9	16.0
KPT FTE-0465	32*1/2	1/2"	31.2	20.2	15.0
KPT FTE-0466	32*3/4	3/4"	31.2	20.2	16.1
KPT FTE-0467	32*1	1"	31.2	20.3	18.3
KPT FTE-0468	40*1-1/4	1 1/4"	39.1	21.3	17.9

Male Threaded Elbow

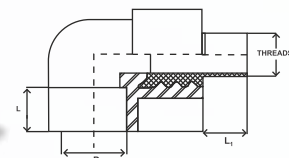

CODE	SIZE	THREADS	D	L	L1
KPT MTE-0481	20*1/2	1/2"	19.2	16.1	15.0
KPT MTE-0483	25*1/2	1/2"	24.1	17.9	15.0
KPT MTE-0484	25*3/4	3/4"	24.2	18.0	14.2
KPT MTE-0485	32*1/2	1/2"	31.3	21.0	14.3
KPT MTE-0486	32*3/4	3/4"	31.3	20.4	15.2
KPT MTE-0487	32*1	1"	31.3	20.1	27.0
KPT MTE-0488	40*1-1/4	1 1/4"	39.0	24.5	21.8

Gate Valve

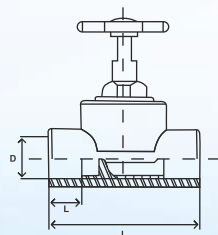

CODE	SIZE	D	L	L1
KPT GV-0501	20 MM	19.0	15.0	60.5
KPT GV-0502	25 MM	24.0	16.8	69.2
KPT GV-0503	32 MM	31.1	20.0	79.5
KPT GV-0504	40 MM	39.0	21.4	92.5
KPT GV-0505	50 MM	48.0	24.0	112.2
KPT GV-0506	63 MM	60.6	26.0	119.1

Male Threaded Union

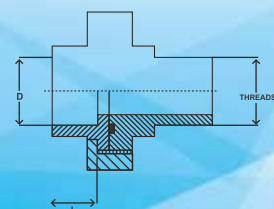

CODE	SIZE	THREADS	D	L
KPT MTU-0521	20*1/2	1/2"	19.2	17.8
KPT MTU-0522	25*3/4	3/4"	24.2	19.0
KPT MTU-0523	32*1	1"	31.3	23.5
KPT MTU-0524	40*1-1/4	1 1/4"	39.2	28.5
KPT MTU-0525	50*1-1/2	1 1/2"	47.6	24.6
KPT MTU-0526	63*2	2"	60.6	28.1

Female Threaded Union

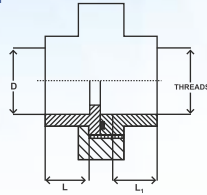

CODE	SIZE	THREDS	D	L	L1
KPT FTU-0541	20*1/2	1/2"	19.2	17.5	18.0
KPT FTU-0542	25*3/4	3/4"	24.2	19.0	18.5
KPT FTU-0543	32*1	1"	31.2	23.6	20.4
KPT FTU-0544	40*1-1/4	1 1/4"	39.2	28.4	23.0
KPT FTU-0545	50*1-1/2	1 1/2"	47.7	23.6	31.5
KPT FTU-0546	63*2	2"	60.6	28.4	28.7

Double Union Ball Valve

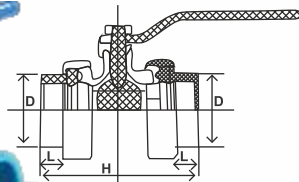

CODE	SIZE	D	L	H
KPT DUBV-0561	20 MM	18.7	16.3	84.1
KPT DUBV-0562	25 MM	23.8	17.4	95.7
KPT DUBV-0563	32 MM	30.8	21.8	107.3
KPT DUBV-0564	40 MM	38.9	25.2	125.3
KPT DUBV-0565	50 MM	48.7	27.3	147.0
KPT DUBV-0566	63 MM	61.4	29.0	168.5

By Pass Bend

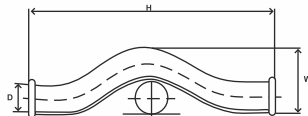

CODE	SIZE	D	W	H
KPT BPB-0581	25 MM	23.9	47.0	94.9
KPT BPB-0582	32 MM	31.2	58.0	106.0

Weld in Saddle Reducer

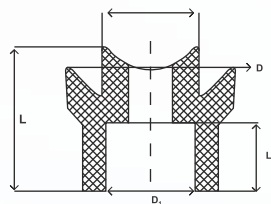

CODE	SIZE	D	D1	L	L1
KPT WIS R-0629	63/32	48.8	30.8	40.2	19.9
KPT WIS R-0630	75/32	48.8	30.8	40.2	19.9
KPT WIS R-0631	90/20	78.5	19.1	62.1	15.5
KPT WIS R-0632	90/25	78.5	24.2	62.1	17.5
KPT WIS R-0633	90/32	78.5	31.0	62.1	19.1
KPT WIS R-0634	90/40	79.2	38.9	62.1	21.4
KPT WIS R-0635	90/50	79.2	48.8	62.1	21.7
KPT WIS R-0636	90/63	79.2	62.7	62.1	27.5
KPT WIS R-0637	110/20	88.0	19.0	66.7	15.5
KPT WIS R-0638	110/25	88.0	24.0	66.7	17.3
KPT WIS R-0639	110/32	88.0	31.0	66.7	19.3
KPT WIS R-0640	110/40	88.0	39.1	66.7	21.5
KPT WIS R-0641	110/50	88.0	48.8	66.7	25.2
KPT WIS R-0642	110/63	88.0	62.4	66.7	27.4
KPT WIS R-0643	160/20	89.8	19.0	62.0	15.6
KPT WIS R-0644	160/25	89.8	23.9	62.0	17.3
KPT WIS R-0645	160/32	89.8	31.2	62.0	19.4
KPT WIS R-0646	160/40	89.8	38.8	62.0	21.3
KPT WIS R-0647	160/50	89.8	49.1	62.0	21.5
KPT WIS R-0648	160/63	89.8	62.5	62.0	27.3
KPT WIS R-0649	200/20	90.2	19.1	66.0	15.6
KPT WIS R-0650	200/25	90.2	24.1	66.0	17.7
KPT WIS R-0651	200/32	90.2	31.2	66.0	19.4
KPT WIS R-0652	200/40	90.2	39.0	66.0	21.4
KPT WIS R-0653	200/50	90.2	48.8	66.0	25.0
KPT WIS R-0654	200/63	90.2	62.5	66.0	27.3

Double Female Elbow with Disk



CODE	SIZE	THREDS	D	L	Z	T
KPT DFEWD -0701	20*1/2	1/2"	18.7	15.8	16.0	149.5
KPT DFEWD -0702	25*1/2	1/2"	24.0	17.6	16.2	149.5

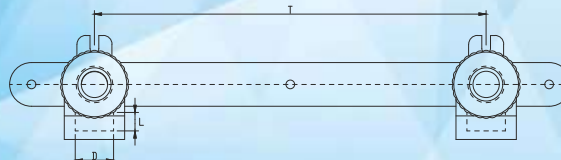

Male Threaded Elbow with Disk

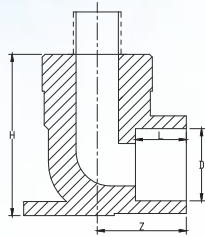

CODE	SIZE	THREADS	D	L	Z	H
KPT MTEWD -0701	20*1/2	1/2"	19.1	15.8	15.0	65
KPT MTEWD -0702	25*1/2	1/2"	24.0	17.6	16.2	70

Female Threaded Elbow with Disk

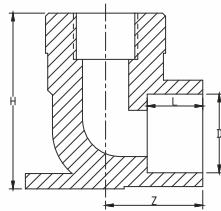

CODE	SIZE	THREADS	D	L	Z	H
KPT FTEWD -0706	20*1/2	1/2"	19.1	15.8	15.0	50
KPT FTEWD -0707	25*1/2	1/2"	24.0	17.6	16.2	55

Male Threaded TEE with Disk

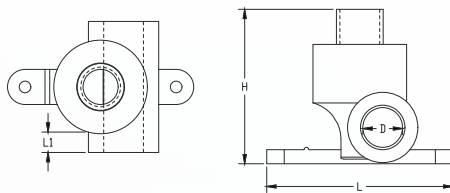

CODE	SIZE	THREADS	D	L	Z	H
KPT MTTWD -0711	20*1/2	1/2"	19.1	16.0	56.0	65
KPT MTTWD -0712	25*1/2	1/2"	24.0	17.2	57.7	70

Female Threaded TEE with Disk

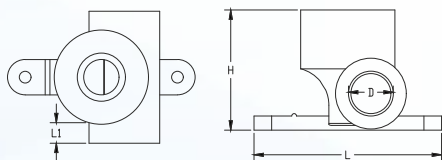

CODE	SIZE	THREADS	D	L	Z	H
KPT FTTWD -0716	20*1/2	1/2"	19.1	16.0	56.0	50
KPT FTTWD -0717	25*1/2	1/2"	24.0	17.2	57.8	56

Concealed Valve



CODE	SIZE	D	L	L1
KPT CV-0721	20 MM	19.0	15.0	60.5
KPT CV-0722	25 MM	24.3	17.2	68.1
KPT CV-0723	32 MM	31.0	20.0	79.7



connection heating & cooling



chilled water technology



swimming-pool technology



chemical transport



irrigation



wall heating



application in the field of ship building



district heating pipeline systems



geothermal



KPT Piping System Private Limited

Regd. Office: Unit no. 305-306, P.P. Trade Center, Plot no. P-1, Netaji Subhash Place,
New Delhi-110034 India

Works: 122/69, Central Hope Town, Selaqui, Industrial Area,
Dehradun-248197 (Uttarakhand)

Ph.: +11-45360050, + 91 8178402742, + 91 9354940961

Email: info@kptpipes.com

Toll Free No.: 1800-270-4672

